

Woolfenden, Mitchell

From: Croke, Isabella
Sent: Wednesday, 6 September 2017 11:05 AM
To: Magee, Alexandra; Westropp, Caitlin
Cc: Chen, Diana
Subject: RE: You've got a payment request [SEC=UNCLASSIFIED]

Hi Alex/Caitlin,

Diana assisted in payment of the Singapore Miracle Tour and Fleur has signed off on a "request for purchase by credit card" form and I have provided this to Diana.

Fleur has just mentioned to me that the Property Council members will need to pay their share of the invoice – 5 of the 8 members on the tour are Property Council.

Could you please organise for them to pay?

Thank you

Isabella Croke | Executive Assistant to Fleur Flanery
Phone: 02 6207 7206 | Email: isabella.croke@act.gov.au
Planning Policy | Environment, Planning and Sustainable Development Directorate | ACT Government
Dame Pattie Menzies House, Challis Street Dickson | GPO Box 158 Canberra ACT 2601 | www.planning.act.gov.au



Follow us on Twitter



Follow us on Facebook

From: Croke, Isabella
Sent: Tuesday, 5 September 2017 2:03 PM
To: Chen, Diana
Subject: FW: You've got a payment request [SEC=UNCLASSIFIED]

Hi Diana,

Could you please assist with payment of the below invoice?

Thank you

Isabella Croke | Executive Assistant to Fleur Flanery
Phone: 02 6207 7206 | Email: isabella.croke@act.gov.au
Planning Policy | Environment, Planning and Sustainable Development Directorate | ACT Government
Dame Pattie Menzies House, Challis Street Dickson | GPO Box 158 Canberra ACT 2601 | www.planning.act.gov.au



Follow us on Twitter



Follow us on Facebook

From: Magee, Alexandra
Sent: Tuesday, 5 September 2017 1:46 PM
To: Westropp, Caitlin; Croke, Isabella
Subject: RE: You've got a payment request [SEC=UNCLASSIFIED]

Thanks Caitlin [REDACTED]

Bella is following up for us on this one.

Alex

From: Westropp, Caitlin
Sent: Tuesday, 5 September 2017 1:26 PM
To: Magee, Alexandra; Croke, Isabella
Subject: RE: You've got a payment request [SEC=UNCLASSIFIED]

Sorry to palm this off on you guys! Nick might be able to help out too if you get stuck.

Thanks for your help :)

Caitlin

From: Flanery, Fleur
Sent: Tuesday 5 September 2017 12:34
To: Magee, Alexandra; Croke, Isabella
Cc: Westropp, Caitlin
Subject: FW: You've got a payment request [SEC=UNCLASSIFIED]

Alex/Isabella

Any chance you could assist Caitlin by identifying a credit card that can be used to pay for the tour and arranging the payment. [REDACTED]
and we promised Ben we'd confirm details today.

Many thanks

From: Croke, Isabella
Sent: Tuesday, 5 September 2017 11:44 AM
To: Westropp, Caitlin
Cc: Magee, Alexandra; Flanery, Fleur
Subject: RE: You've got a payment request [SEC=UNCLASSIFIED]

Hi Caitlin,

Unfortunately no one in Planning Policy has a credit card – I am in the process of getting one.

Sorry I can't help!

Diana Chen would be your best bet.

Thank you

Isabella Croke | Executive Assistant to Fleur Flanery
Phone: 02 6207 7206 | Email: isabella.croke@act.gov.au
Planning Policy | Environment, Planning and Sustainable Development Directorate | ACT Government
Dame Pattie Menzies House, Challis Street Dickson | GPO Box 158 Canberra ACT 2601 | www.planning.act.gov.au



From: Westropp, Caitlin
Sent: Tuesday, 5 September 2017 11:42 AM
To: Flanery, Fleur

Cc: Magee, Alexandra; Croke, Isabella

Subject: FW: You've got a payment request [SEC=UNCLASSIFIED]

Hi Fleur,

The Singapore tour company has sent through payment details, but [REDACTED] so we can't use her credit card. Do you or Isabella know if someone in the Planning Policy area has a corporate credit card we could use to pay for this? If not, I know Diana Chen in Finance has a corporate credit card - Alex maybe you could liaise directly with her as a back up? It would be good to organise payment today as this is only two days away now.

Let me know if there are any issues.

Thanks,
Caitlin

From: Magee, Alexandra

Sent: Tuesday 5 September 2017 11:27

To: Westropp, Caitlin; Vest, Petra

Subject: RE: You've got a payment request [SEC=UNCLASSIFIED]

Hi Caitlin,

[REDACTED] I dont have a credit card! Is there anyone in your team who has a corporate credit card that we can book with and reimburse?

Alex

From: Westropp, Caitlin

Sent: Tuesday, 5 September 2017 11:18 AM

To: Vest, Petra

Cc: Magee, Alexandra

Subject: FW: You've got a payment request

Hi Petra,

Do you mind organising payment for the below bus tour in Singapore? They said we can pay with credit card without a PayPal account - fingers crossed we don't have the same issues as last time!

Let me know how you go.

Thanks,
Caitlin

From: service@paypal.com.sg [service@paypal.com.sg]

Sent: Tuesday 5 September 2017 11:12

To: Westropp, Caitlin

Subject: You've got a payment request

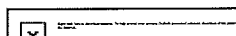

Hello Caitlin.Westropp@act.gov.au





Betel Box Asia Pte Ltd sent you a payment request.

Note from Betel Box Asia Pte Ltd:

 This is the updated paypal payment of 
S\$1260 (including 5% paypal admin fee)
for the Singapore Miracle Tour for 8
persons on 7th September 2017 at 9.
30am. Kindly make payment as soon as
possible to confirm the tour.

Payment request details

Transaction ID: U-4U5269597V895824V

5 September 2017

Amount requested

\$1,260.00 SGD

Pay Now

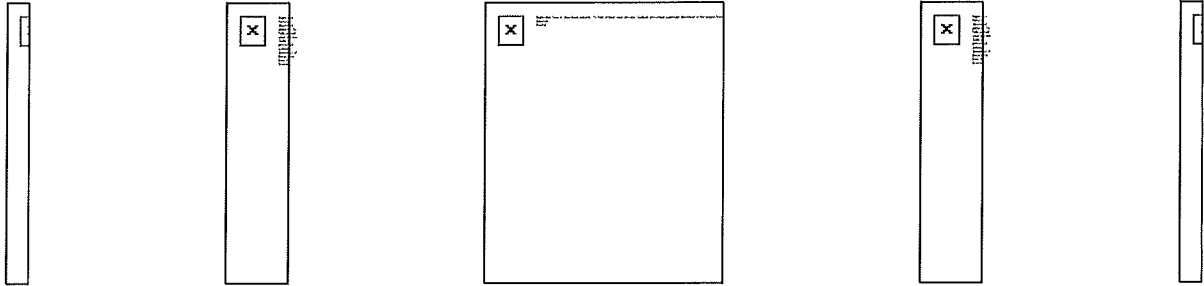

[Help & Contact](#) | [Security](#) | [Apps](#)

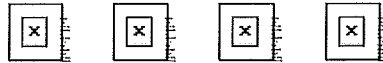

PayPal is committed to preventing fraudulent emails. Emails from PayPal will always contain your full name. To learn more, please go to the PayPal website and click **Security** at the bottom of the page.

Please do not reply to this email. To get in touch with us, click **Help & Contact**.

Copyright © 1999 – 2017 PayPal. All rights reserved.

Consumer advisory - PayPal Pte. Ltd. the holder of PayPal's stored value facility, does not require the approval of the Monetary Authority of Singapore. Users are advised to read the terms and conditions carefully.

PayPal PPC001017:bb014720c0aab



You made a payment to Betel Box Asia Pte Ltd.

5 Sep 2017 14:18:36 AEST
Receipt No: 1199-7596-7346-4467

Dear Diana Chen Environment, Planning and Sustainable Development,

This charge will appear on your credit card statement as payment to PAYPAL
*BETELBOXASI.

Merchant information:
Betel Box Asia Pte Ltd
info@betelbox.com
<http://www.betelbox.com>
62477340

Instructions to merchant:
None provided

Shipping information:
Diana Chen Environment, Planning and Sustainable Development
16 Challis ST
Dame Pattie Menzies House
Dickson, Australian Capital Territory 2602
Australia

Shipping method:
Not specified

Description	Unit price	Qty	Amount
-------------	------------	-----	--------

Purchase from Betel Box Asia Pte Ltd			
--------------------------------------	--	--	--

Total:	\$1,260.00 SGD
---------------	-------------------

Exchange rate: 1 AUD = 1.03310 SGD

Amount you'll pay (transaction currency):	\$1,219.63 AUD
---	-------------------

Receipt No: 1199-7596-7346-4467

Please keep this receipt number for future reference. You'll need it if you contact customer service at Betel Box Asia Pte Ltd or PayPal.

Use PayPal next time!

It looks as if you already have a PayPal account.

When you shop online, it's faster and easier to check out with PayPal. Your financial information is securely stored and never shared with merchants when you pay.

Sincerely,
PayPal

[Help](#) | [Security](#)

Currency conversion:

We can confirm that you have been offered a choice of currencies and agreed to pay in the currency identified above (Amount you'll pay).

Based on the choice you made, PayPal converted the payment amount to the currency of your card, instead of your merchant's currency. PayPal's foreign exchange rate is 4.00% above the rate provided by our financial partners.

Copyright © 1999-2017 PayPal Australia Pty Limited ABN 93 111 195 389 (AFSL 304962). All rights reserved.

PayPal Email ID PP1469 - 80f46dfdd53ae

This email, and any attachments, may be confidential and also privileged. If you are not the intended recipient, please notify the sender and delete all copies of this transmission along with any attachments immediately. You should not copy or use it for any purpose, nor disclose its contents to any other person.



American Express Business Travel Account Statement

Account Name: ESDD-PLANNING POLICY
Travel Office: QBT-50128382187

Account Number: [REDACTED]
Travel Office Phone No.: [REDACTED]
Statement Date: 29 Aug 2017

New Debits - Continued

Stnt Ref/ Invoice No.	Supplier Name - ABN/ Comment 1	Traveler's Name/ Ticket Number	Inv. Date/ Dep. Date	Routing Info	Job No./ Comment	TR/ CR	Amount (\$) Tax (\$)	Total Amount (\$)
17241 00093 1602670	THE LIDO GR 4206882981	PONTONBEN LIDO	28/08/2017 27/08/2017	Prague Marr ot Hole *	Environment and Sus*		Vest, Petra 12360	1,231.21 * 1,231.21 ✓

*Please refer to the Excel Statement for full display of this data reference.

Continued on Next Page...

FOR ASSISTANCE CONTACT OUR CUSTOMER SERVICE UNIT -- PHONE : 1300 655 354 Email: bra.client.services@aexp.com
AMERICAN EXPRESS AUSTRALIA LTD. GPO Box 3928, Sydney NSW 2001



American Express Business Travel Account Statement

Account Name: ESDD-PLANNING POLICY
Travel Office: QBT-50128382187

Account Number: [REDACTED]
Travel Office Phone No.: [REDACTED]
Statement Date: 29 Sep 2017

New Debits - Continued

Invoice No.	Supplier Name - ABN/ Comment 1	Traveler's Name/ Ticket Number	Inv. Date/ Dep. Date	Routing Info	Job No/J Comment	TR/ CR	Amount (\$) Tax (\$)	Total Amount (\$)
17243 00005	THE LIDO GR* 42006852991	PONTON/BEN	30/08/2017	Brussels Mar	Environment and Sus*		314.75	314.75
1604955		LIDO	30/08/2017	rott Ho *			0.00	
17244 00009	THE LIDO GR* 42006852991	PONTON/BEN	31/08/2017	Radisson Blu	Environment and Sus*		1,729.65	1,729.65
1606632		LIDO	31/08/2017	Scandin *			0.00	

*Please refer to the Excel Statement for full display of this data reference.

Continued on Next Page...



American Express Business Travel Account Statement

Account Name: ESDD-PLANNING POLICY
Travel Office: QBT-50128382187

Account Number: [REDACTED]
Travel Office Phone No.: [REDACTED]
Statement Date: 29 Sep 2017

New Debits - Continued

Stmnt Ref	Supplier Name - ABN/ Comment 1	Ticket Number	Inv. Date/ Dep. Date	Routing Info City Ce *	Job No./ Comment	TRJ	Amount (\$)	Tax (\$)	Amount (\$)	Total
17248 00027 1601753	THE LIDO GR* 42006852991	POINTON/BEN LIDO	04/09/2017 03/09/2017	Crowne Plaza City Ce *	West, Petra 12360	CR	2,067.88	0.00	2,067.88	2,067.88



*Please refer to the Excel Statement for full display of this data reference.

Continued on Next Page...



ACT
Government

Chief Minister, Treasury and
Economic Development

Tax Invoice

CHIEF MINISTER

ABN: 21 869 198 926

Invoice To	Details
EPSDD - ENVIRONMENT, PLANNING AND SUSTAINABLE DEVELOPMENT DIRECTORATE Dame Pattie Menzies House GPO Box 158 CANBERRA ACT 2601 Attention: Petra Vest	Customer Number: 192650 Invoice Number: 20105453 Invoice Date: 08-SEP-2017 Payment Terms: 30 DAYS NET Due Date: 08-OCT-2017 Amount Payable: \$11,935.22

Page:1 of 1

Line	Description	Qty	Unit	Unit Price	Total exc GST	GST	Total inc GST
001	Travel Fares - Ben Ponton EPSDD.	1		\$11,931.92	\$11,931.92	\$0.00	11,931.92
002	Travel Booking Fee - Ben Ponton EPSDD.	1		\$3.00	\$3.00	\$0.30	3.30

petra.vest@act.gov.au

Invoice Totals:

\$11,934.92

\$0.30

\$11,935.22

Payment enquiries should be directed to: Chief Minister Accounts Receivable (02) 6205 2171

Invoice enquiries should be directed to: Chadia Rad 62050214

EFT payments can be made to:

BSB Number: 037-843

Account Number: 380192650

Reference: 20105453

Account Name: ACT Government Account

Please return this section with your
payment to:

Shared Services Accounts Receivable
GPO BOX 158
CANBERRA CITY ACT 2601

Fax: (02) 620 53201

Email: SharedServicesAccountsReceivable@act.gov.au

Customer Number: 192650

Invoice Number: 20105453

Invoice Date: 08-SEP-2017

Due Date: 08-OCT-2017

Amount Payable: \$11,935.22

No receipt mailed unless requested



American Express Business Travel Account Statement

Account Name: CMTD-POLICY AND CABINET
Travel Office: QBT-50128382187

Account Number: [REDACTED]
Travel Office Phone No.: [REDACTED]
Statement Date: 29 Aug 2017

New Debits - Continued

Invoice No.	Start Ref	Supplier Name	ABN / Comment 1	Traveler's Name / Ticket Number	Inv. Date / Deb. Date	Routing Info	Job No. / Comment	TR / CR	Amount (\$)	Tax (\$)	Total Amount (\$)
17228 00024	0163919	QANTAS AIRW*	16009661901	PONTONBM 56020432954	19/08/2017	CBRMEL			258.75		258.75
17227 00048	0163919	SINGAPORE A*	52001056195	PONTONBM 56020432955	25/08/2017	MEUSINFRA	LWYLYKZ		25.88		25.88
17228 00021	0163919	QBT PTY LTD	128382187	PONTONBM Complex Int	14/08/2017	MUCSIN	LWYLYKZ		123.00	0.00	123.00
17228 00022	0163919	QBT PTY LTD	128382187	PONTONBM Voas Admin	28/08/2017	FRAPRG	LWYLYKZ		123.00	0.00	123.00
17229 00028	0163919	DEUTSCHE LU*		PONTONBM 56020432645	14/08/2017	FRAPRG	LWYLYKZ		727.00		727.00
17228 00029	0163919	DEUTSCHE LU*		PONTONBM 56020489813	14/08/2017	FRAPRG	LWYLYKZ		843.70		843.70
17229 00025	0168449	CSA - BSP A*		PONTONBM 56020624262	15/08/2017	PRGBRU	LWYLYKZ		516.60		516.60
17227 00023	0163919	BRUSSELS AI*		PONTONBM 56020432554	30/08/2017	BRU/CPH	LWYLYKZ		861.00		861.00
17227 00020	0163919	AIR BERLIN*		PONTONBM 56020424864	14/08/2017	CPH/TXL	LWYLYKZ		386.50		386.50
17229 00027	0163919	DEUTSCHE LU*		PONTONBM 56020432543	09/09/2017	TOLMUC	LWYLYKZ		740.60		740.60

*Please refer to the Excel Statement for full display of this data reference.

Total New Debits

15765.23
283.13

15046.86

Journal Name	Journal Line	Acct Date	Transaction Date	Category	GL Batch	Receipt Batch
18-SEP-2017 Purchase Invoices AUD	3935	18/09/2017	29/08/2017	Purchase Invoices	Payables A 1967721 14053983	
18-SEP-2017 Purchase Invoices AUD	152	18/09/2017	29/08/2017	Purchase Invoices	Payables A 1967721 14053983	
28-SEP-2017 Purchase Invoices AUD	1247	28/09/2017	08/09/2017	Purchase Invoices	Payables A 1973721 14073566	
25-OCT-2017 Purchase Invoices AUD	804	25/10/2017	29/09/2017	Purchase Invoices	Payables A 2024721 14142192	
25-OCT-2017 Purchase Invoices AUD	806	25/10/2017	29/09/2017	Purchase Invoices	Payables A 2024721 14142192	
25-OCT-2017 Purchase Invoices AUD	808	25/10/2017	29/09/2017	Purchase Invoices	Payables A 2024721 14142192	

AP Invoice Batch	Source	E	CC Description	NA	IT Description	PR Description
PM171800474	Payables	120	12360 Director General (Chief Planning Executive)	711406	99 External	99999 Not Specific
PM171800474	Payables	120	99999 Non Specific	111285	99 External	99999 Not Specific
PM171800566	Payables	120	12360 Director General (Chief Planning Executive)	711407	14 Chief Minister	99999 Not Specific
PM171800707	Payables	120	12360 Director General (Chief Planning Executive)	711406	99 External	99999 Not Specific
PM171800707	Payables	120	12360 Director General (Chief Planning Executive)	711406	99 External	99999 Not Specific
PM171800707	Payables	120	12360 Director General (Chief Planning Executive)	711406	99 External	99999 Not Specific

AU Description	SP	Natural Account Description	Tax Code
9999 Non Specific	9999	711406 Travel Fares (Domestic)	10% AP
9999 Non Specific	9999	111285 GST Paid on Receipt of Good or Service	10% AP
9999 Non Specific	9999	711407 Travel Fares (Overseas)	Free AP
9999 Non Specific	9999	711406 Travel Fares (Domestic)	Outside AP
9999 Non Specific	9999	711406 Travel Fares (Domestic)	Outside AP
9999 Non Specific	9999	711406 Travel Fares (Domestic)	Outside AP

Description

INV: 376059434971000-29/08/17 ; AMERICAN EXPRESS AUSTRALIA LIMITED ; B PONTON ACC PRAGUE 21/8/17 : Dist ID 35861081

INV: 376059434971000-29/08/17 ; AMERICAN EXPRESS AUSTRALIA LIMITED ; B PONTON ACC PRAGUE 21/8/17 : Dist ID 35861210

INV: 20105453 ; CHIEF MINISTER TREASURY AND ECONOMIC DEVELOPMENT DIRECTORATE CONTROLLED ACCOUNT ; BEN PONTON 25/08/17-06/09/17 : Dist ID 359:

INV: 376059434971000-29/09/17 ; AMERICAN EXPRESS AUSTRALIA LIMITED ; B PONTON ACC 30/08/17 : Dist ID 36083686

INV: 376059434971000-29/09/17 ; AMERICAN EXPRESS AUSTRALIA LIMITED ; VARIOUS : Dist ID 36107510

INV: 376059434971000-29/09/17 ; AMERICAN EXPRESS AUSTRALIA LIMITED ; B PONTON ACC 31/08/17 : Dist ID 36083688

Debit	Credit	YTD Expenditure	Vendor/Customer Name
1,119.28		1,119.28	AMERICAN EXPRESS AUSTRALIA LIMITED
111.93		111.93	AMERICAN EXPRESS AUSTRALIA LIMITED
11,931.92		11,931.92	CHIEF MINISTER TREASURY AND ECONOMIC DEVELOPMENT DIRECTORATE CONTROLLED ACCOUNT
314.75		314.75	AMERICAN EXPRESS AUSTRALIA LIMITED
1,729.65		1,729.65	AMERICAN EXPRESS AUSTRALIA LIMITED
2,067.88		2,067.88	AMERICAN EXPRESS AUSTRALIA LIMITED

Vendor/Customer Number	Trans Number	Assoc Trans	Line	Transaction Type	Transaction Amount	Invoice Line Description
	1362 376059434971000-29/08/17		39	Item Expense	1119.28	B PONTON ACC PRAGUE 21/8/17
	1362 376059434971000-29/08/17		39	Recoverable Tax	111.93	B PONTON ACC PRAGUE 21/8/17
100256		20105453	1	Item Expense	11931.92	BEN PONTON 25/08/17-06/09/17
	1362 376059434971000-29/09/17		49	Item Expense	314.75	B PONTON ACC 30/08/17
	1362 376059434971000-29/09/17		95	Item Expense	1729.65	VARIOUS
	1362 376059434971000-29/09/17		51	Item Expense	2067.88	B PONTON ACC 31/08/17

Woolfenden, Mitchell

From: Copenhagen Urban Adventures <service@paypal.dk>
Sent: Monday, 21 August 2017 4:16 PM
To: Westropp, Caitlin
Subject: Invoice from Copenhagen Urban Adventures (0002)

Hello, petra.vest@act.gov.au

Here's your invoice

Copenhagen Urban Adventures sent you an invoice for 1.170,00 DKK

Due on receipt

[View and Pay Invoice](#)

Note from Copenhagen Urban Adventures

Private tour for 5 people on September 3rd



[Help & Contact](#) | [Security](#) | [Apps](#)



How do I know this is not a Spoof email?

PayPal is committed to preventing fraudulent emails. Emails from PayPal will always contain your full name. Spoof or 'phishing' emails tend to have generic greetings such as "Dear PayPal member". To learn more go to the PayPal website and click **Security**.

Please do not reply to this email. To get in touch with us, click **Help & Contact**.

Copyright © 1999-2017 PayPal. All rights reserved. PayPal (Europe) S.à r.l. et Cie, S.C.A. Société en Commandite par Actions Registered Office: 22-24 Boulevard Royal, L-2449 Luxembourg RCS Luxembourg B 118 349

PayPal PPC000977:f484fc66e7e20

Fakturaoplysninger

Udskriv/PDF

i Forsendelses- og faktureringsoplysningerne er blevet skjult for at beskytte dine personlige oplysninger. Log på for at se denne faktura, eller bed sælgeren om at sende dig en PDF-kopi.

Fakturaen blev redigeret 24. aug. 2017 kl. CEST

FAKTURA

Copenhagen Urban Adventures

Betalt

Faktura-nr.: 0002
 Fakturadato: 21. aug. 2017
 Forfaldsdato: 21. aug. 2017

Forfaldent beløb:
0,00 DKK

Send faktura til:

pe*****@act.gov.au

Beskrivelse	Antal	Pris	Beløb
Private tour September 3rd	3	325,00 DKK	975,00 DKK
		Subtotal	975,00 DKK
		Vat (20%)	195,00 DKK
		I alt	1.170,00 DKK
		Betalt beløb	-1.170,00 DKK
		Forfaldent beløb	0,00 DKK

Noter

Private tour for 5 people on September 3rd

Leveret af **PayPal**

Copyright © 1999- PayPal. Alle rettigheder forbeholdes.

Minister Gentleman and Senior Adviser
Travel Europe 26 August - 7 September 2017
European Union World Cities Project

Category	Expense
Airfares	\$24,880.51
Accommodation	\$9,552.53
Travel Allowance	\$6,952.78
Transport/taxi	\$171.94
Total	\$41,557.76



EUROPEAN UNION AND SINGAPORE

12-DAY STUDY TOUR



ACT
Government

PARTNERSHIPS



**UNIVERSITY OF
CANBERRA**



World Cities

*EU - Third Countries Cooperation on
Urban and Regional Development*



**PROPERTY
COUNCIL
of Australia**

© Australian Capital Territory, Canberra 2017

This work is copyright. Apart from any use as permitted under the *Copyright Act 1968*, no part may be reproduced by any process without written permission from:

Director-General, Environment and Planning Directorate,
ACT Government, GPO Box 158, Canberra ACT 2601.

Telephone: 02 6207 1923

Website: www.planning.act.gov.au

Accessibility

The ACT Government is committed to making its information, services, events and venues as accessible as possible.

If you have difficulty reading a standard printed document and would like to receive this publication in an alternative format, such as large print, please phone Access Canberra on 13 22 81 or email the Environment and Planning Directorate at epd_communications@act.gov.au

If English is not your first language and you require a translating and interpreting service, please phone 13 14 50.

If you are deaf, or have a speech or hearing impairment, and need the teletypewriter service, please phone 13 36 77 and ask for Access Canberra on 13 22 81.

For speak and listen users, please phone 1300 555 727 and ask for Access Canberra on 13 22 81.

For more information on these services visit <http://www.relayservice.com.au>

Study tour Facilitator and Planning

Caitlin Westropp

Nicholas Wales



PRINTED ON RECYCLED PAPER

INTRODUCTION

The ACT Government has a significant commitment to sustainable development and urban renewal initiatives supporting a vibrant and sustainable Canberra for all. This report details the key learnings of a delegation of ACT Government and Property Council members visiting Prague and Brussels as part of the European Union (EU) World Cities program from 27 August to 31 August 2017. The report also outlines the learnings from a study tour of Copenhagen, Berlin and Singapore that the delegates completed from 1 September to 7 September 2017.

The delegation visited cities that demonstrate best-practice examples of urban innovation, environmental sustainability and smart city initiatives to take away key learnings that can inform projects in the ACT.

The tour was designed to focus on five key themes:

1. DESIGN INNOVATION

Incorporating innovative design into our cities to ensure they are attractive, usable and enjoyable places to live. Looking at best practice architecture and urban design across Europe and Singapore provides insight into how the planning system can facilitate good design, with a focus on how the built form intersects with new technology to create innovative buildings and places that enhance our environment.

2. SUSTAINABLE DEVELOPMENT

There is an opportunity to learn from some of the cutting-edge green technology and design that is being implemented to support Canberra's ongoing investment in sustainable development to create a carbon-neutral city. Cities such as Copenhagen and Berlin provide examples on how Government and the private sector can reduce greenhouse gas emissions and slow the effects of climate change. Learning about innovative green buildings and renewable energy resources will enable government to consider how Canberra can continue to support sustainable development.

3. GREEN INFRASTRUCTURE AND PARKS

Canberra is the envy of many cities as a result of its extensive open space network. It is also one of the most valued attributes for many Canberrans. As the need to increase density intensifies so too will the pressure to utilise open space. Copenhagen and Singapore are at the forefront of creating successful urban open spaces, parks and green infrastructure that responds to people, place and the environment. Opportunities to optimise our green space to enhance sustainable urban communities was of key interest.

4. COMMUNITY-LED INITIATIVES AND PLACEMAKING

Successful placemaking and community-led initiatives in Copenhagen and Berlin have seen the transformation of dilapidated industrial areas into attractive and diverse urban neighbourhoods. Research shows that bottom-up planning initiatives can be hugely successful in not only improving the quality of the urban fabric of a city, but also in strengthening community connections and a sense of ownership and belonging. Investigating community driven placemaking, activation and urban initiatives throughout the study tour will provide inspiration for how the government can support similar initiatives in Canberra.

5. INTEGRATION WITH SMART TECHNOLOGY

Prague and Copenhagen's strategy to incorporate smart technology into urban infrastructure demonstrates how modern technology can improve city living. Initiatives such as embedding sensor technology into public transport, street lighting and signage demonstrates how urban development can integrate with new information and communications technology to improve the liveability, sustainability and efficiency of our city.



ABOUT THE EUROPEAN UNION (EU) WORLD CITIES PROGRAM

World Cities is a project of the Directorate General for Regional and Urban Policy of the European Commission in the framework of the European Parliament's preparatory action to promote the exchange of experience and best practice between the European Union (EU) and non-EU countries on territorial development with particular reference to urban development, urban-rural partnerships and urban cross-border cooperation. Actions are designed to increase so called 'triple-helix cooperation' between governments, research and business.

Canberra (Australia) was partnered with Prague (Czech Republic) as part of the program. A Letter of Intent was signed by the ACT Government and the Prague Startup Centre on 29 August 2017 committing to exchange experiences and best practice delivered through a commitment to the following activities:

- Mutual exchange regarding renewable and sustainable energy initiatives
- Collaboration for the development of sustainable transport solutions
- Mutual exchange regarding smart city technologies and implantation
- Collaboration for the development of community services and affordable housing solutions
- Mutual exchange of delegations that connect businesses of each city
- Jointly support innovation and entrepreneurship through the collaboration of start-up ecosystems.

Canberra and Prague will continue to develop their relationship through a number of key exchanges:

- EU World Cities meeting in Canberra in March 2018
- Representative of the European Space Agency Business Incubation Centre Prague invited to deliver workshop in Canberra on supporting business to develop space-related technology
- Joint support for innovation and entrepreneurship through collaboration on start-ups and developing an exchange program
- Ongoing exchange of knowledge and learnings in relation to urban renewal and business innovation

Three other Australia cities took part in the 2017 program which included Adelaide, Hobart and Melbourne.

The tour of Prague and Brussels reciprocates a Prague delegation's visit to Canberra in May 2017.



LEFT TO RIGHT: JEREMY MATHER, GEORGE D KATHEKLAKIS, BEN PONTON, ADINA CIRSON, MICK GENTLEMAN, BETHEL SENDEBA, ARABELLA ROHDE, SUZANNE MOULIS.

DELEGATES

Mick Gentleman

MINISTER FOR PLANNING AND LAND MANAGEMENT FOR THE AUSTRALIAN CAPITAL TERRITORY (ACT)

Bethel Sendaba

MINISTER'S SENIOR ADVISOR

Ben Ponton

DIRECTOR-GENERAL, ACT ENVIRONMENT PLANNING AND SUSTAINABLE DEVELOPMENT DIRECTORATE

Adina Cirson

ACT EXECUTIVE DIRECTOR OF THE PROPERTY COUNCIL OF AUSTRALIA

George D Katheklakis

MANAGING DIRECTOR OF THE KDN GROUP AND PRESIDENT OF THE PROPERTY COUNCIL OF AUSTRALIA

Arabella Rohde

SENIOR DEVELOPMENT MANAGER AT THE UNIVERSITY OF CANBERRA AND MEMBER OF THE PROPERTY COUNCIL MANAGEMENT COMMITTEE / CHAIR OF PLANNING AND SUSTAINABLE DEVELOPMENT COMMITTEE

Suzanne Moulis

CHIEF EXECUTIVE OF MOULIS LEGAL AND CHAIR OF THE PROPERTY COUNCIL DIVERSITY COMMITTEE

Jeremy Mather

DIRECTOR, MATHER ARCHITECTURE

EUROPEAN UNION (EU) WORLD CITIES PROGRAM TOUR

PRAGUE CZECH REPUBLIC

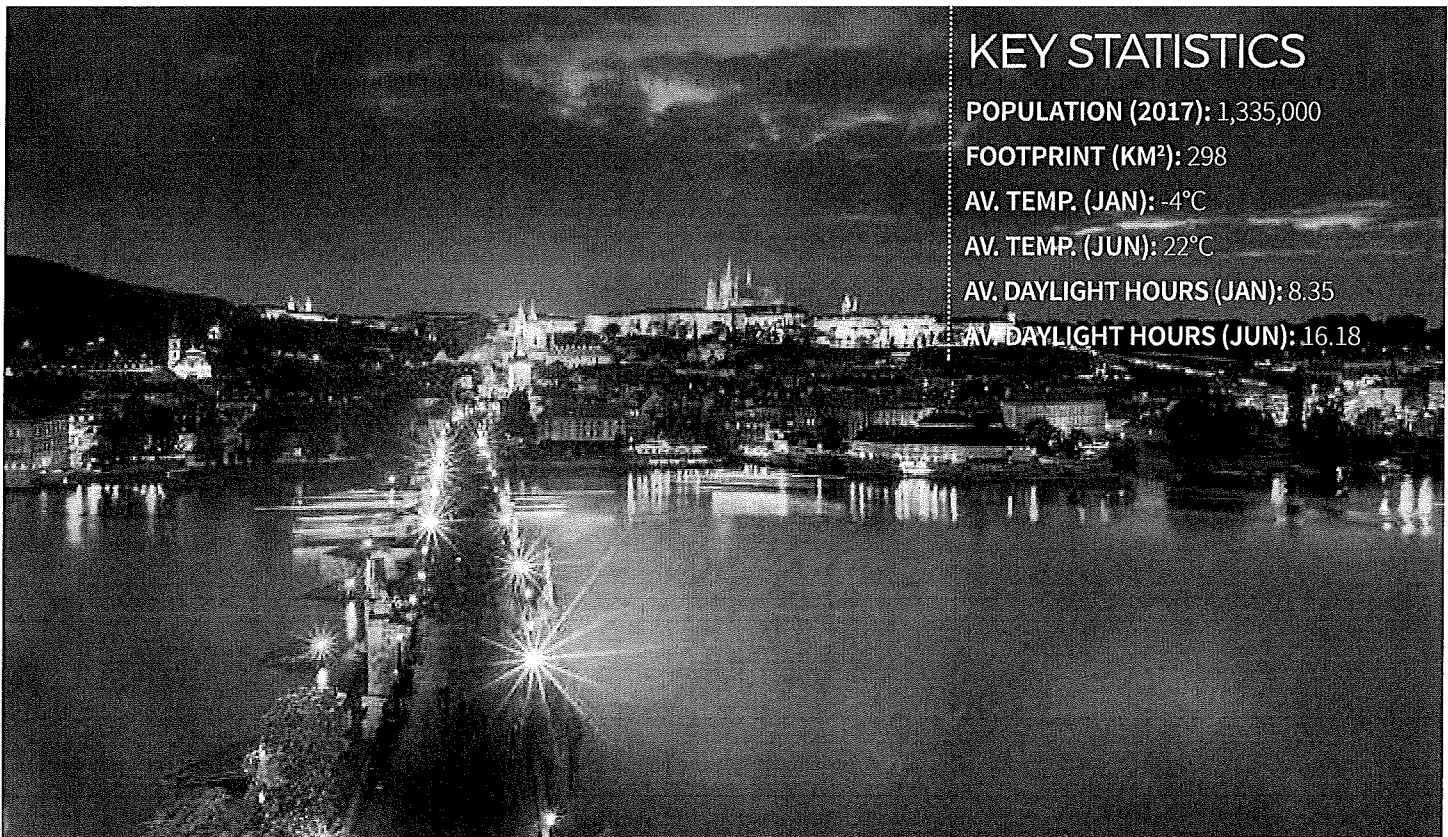

KEY STATISTICS

POPULATION (2017): 1,335,000
FOOTPRINT (KM²): 298
AV. TEMP. (JAN): -4°C
AV. TEMP. (JUN): 22°C
AV. DAYLIGHT HOURS (JAN): 8.35
AV. DAYLIGHT HOURS (JUN): 16.18

WHAT THEY DID

- Delegates met with the Vice-Mayor of Prague for Urban Development and took a city tour to key districts, landmarks and areas of urban renewal including the Holesovic and Vinhary districts.
- Meetings were held with a number of business incubators that mentor and assist early-stage entrepreneurs.
- Delegates met with Prague's official municipal company implementing smart city solutions to improve the functionality of infrastructure, building energy performance and communication with citizens. A meeting was also held with the University Centre for Energy Efficient Building to learn about the latest energy efficient building innovations.

WHAT THEY LEARNT

BUILT FORM

- Heritage preservation which focuses on the use and values of the space is just as important as conserving its built form.
- Targeted industry research and development has enabled the development of regional expertise in renewable energy and building energy efficiency.

BRUSSELS

BELGIUM

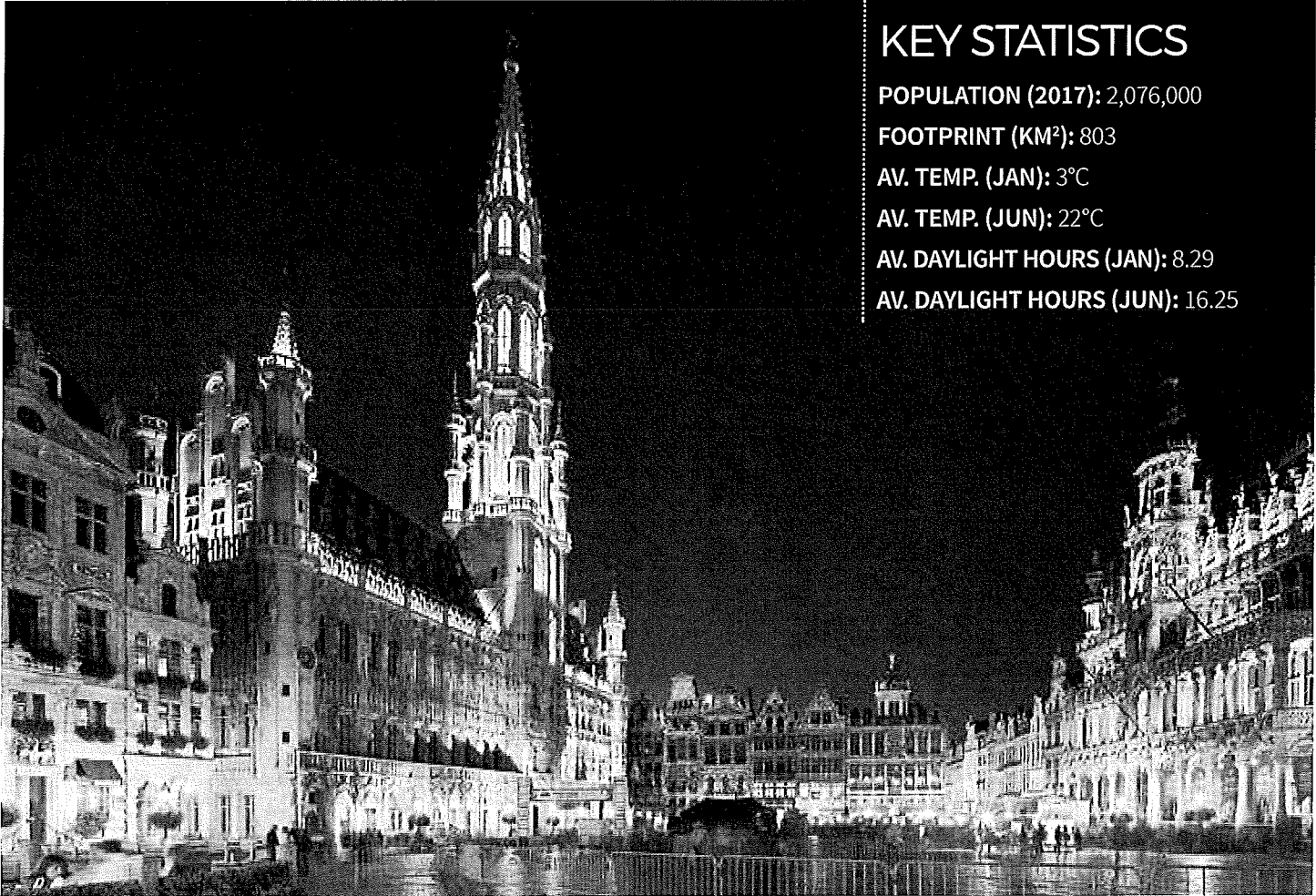

KEY STATISTICS

POPULATION (2017): 2,076,000

FOOTPRINT (KM²): 803

AV. TEMP. (JAN): 3°C

AV. TEMP. (JUN): 22°C

AV. DAYLIGHT HOURS (JAN): 8.29

AV. DAYLIGHT HOURS (JUN): 16.25

WHAT THEY DID

- Delegates met with members of the European Parliament.
- Delegates travelled to Ghent to see how heritage precincts and buildings successfully integrate new developments through innovative design.

WHAT THEY LEARNT

BUILT FORM

- Modern building facades can integrate respectfully with heritage facades through thoughtful design.

GOVERNANCE

- Brussels approach to policy development is to identify a small number of objectives than numerous.
- Governments need to take an innovative approach to governing for our cities and not be afraid to take risks.

KEY MESSAGES

- Governments and communities need to be bold and confident to take informed risk, and be willing to try again if it does not work the first time, to learn from the experience.
- Innovation will be a key to improving and enhancing user experiences.
- Cities should seek to respect heritage rather than replicate.

USEFUL LINKS

- Ghent Market Hall: <https://arcSPACE.com/feature/ghent-market-hall/>.

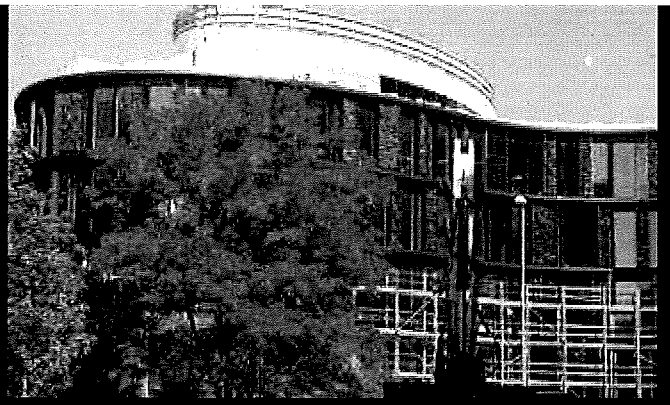

THE STUDY TOUR

COPENHAGEN

DENMARK



KEY STATISTICS

POPULATION (2017): 1,294,000

FOOTPRINT (KM²): 616

AV. TEMP. (JAN): 2°C

AV. TEMP. (JUN): 18°C

AV. DAYLIGHT HOURS (JAN): 7.44

AV. DAYLIGHT HOURS (JUN): 17.26

WHAT THEY DID

- Delegates met with world renowned multidisciplinary organisations working in the urban design and environmental sustainability arena, including Gehl People and Ramboll Consultants.
- A city bike tour allowed delegates to experience first-hand how the world's most liveable city feels and functions for everyday citizens. It also showcased the different pockets of the city – from declining industrial areas to active neighbourhoods and cultural areas.

WHAT THEY LEARNT

BUILT FORM

- Areas of Copenhagen provide car parking away from the residential buildings (less than 200m away) creating an active communal ground level with reduced driveways and garages.
- These independent car parks are multi-purposed to offer green space and playgrounds.
- Apartment buildings are built with a 0-600mm setback to the block boundary with balconies permitted to overhang the public domain.

COMMUNITY PARTICIPATION

- Copenhagen has developed a culture of community engagement and is viewed as 'business as usual'.
- Engagement occurs proactively rather than waiting for an issue to arise.
- The community is involved in planning strategies and outcomes.
- Participation levels are improved by involving the community in a wide range of topics and issues, not just planning (e.g. 'what is your favourite ice-cream flavour') and creating a sense of fun.

FUNDING MODELS

- The government borrowed funds to finance the construction of a new metro system in an under-valued land area between the city and airport. This enabled the government to realise a land value increase in the order of 5000% which was able to pay off the metro system within a few years of completion.

GREEN INFRASTRUCTURE AND PARKS

- The city is planned with a social consciousness, with consideration given to minimise gentrification resulting from redevelopments and improve homelessness.
- A number of parks have been designed to accommodate homeless people by designing public furniture such as seating and eating areas that convert to shelters and beds for the homeless.
- The design of public open space in the city allows for greater emphasis on smaller quantity, higher quality formal open space, particularly in areas of high density.

GOVERNANCE

- The creation of a new city policy arrangement allowed for the Government to transition from a consent authority to a facilitation role with the community.
- A review of departments has tried to remove the traditional silos that reduced public realm outcomes (e.g. separate planning, municipal, verge management departments).
- Copenhagen has a rent control system to ensure change of use and competing land uses are managed. Rent increase can only be achieved if it is demonstrated that improvements have been made.

SMART CITIES

- 'Street Lab' is Copenhagen's test area for smart city solutions comprising of two streets used to test and demonstrate technologies to citizens, decision-makers and companies.
- Current smart city initiatives include 'Green Wave' traffic lights used to improve cycle flow during peak hours. When cyclists are travelling at an average of 18-20km/h, all traffic lights will be green enabling continuous and efficient travel.
- Innovation is supported by the provision of networks, partnerships, rental accommodation and support services. Larger companies now support smaller start ups and innovation growth rather than simply trying to compete.

SUSTAINABLE TRANSPORT

- Government policy to reduce the ability of cars to enter the city by 2-3% per annum (by converting roads to bicycle lanes) has gradually reduced car dependency over 10 years.

KEY MESSAGES

- Cities need to be designed for people oriented transport rather than cars, which includes understanding people's wants and needs.
- Develop an engagement culture to raise levels of public participation on city and state planning issues.
- Participation levels increase when engagement techniques incorporate a sense of fun.

USEFUL LINKS

- Copenhagen Solutions Lab – Street Lab: <http://cphsolutionslab.dk/>
- Gehl People: <http://gehlpeople.com/>
- Ramboll Consultants: <http://www.ramboll.com/planning-and-urban-design>



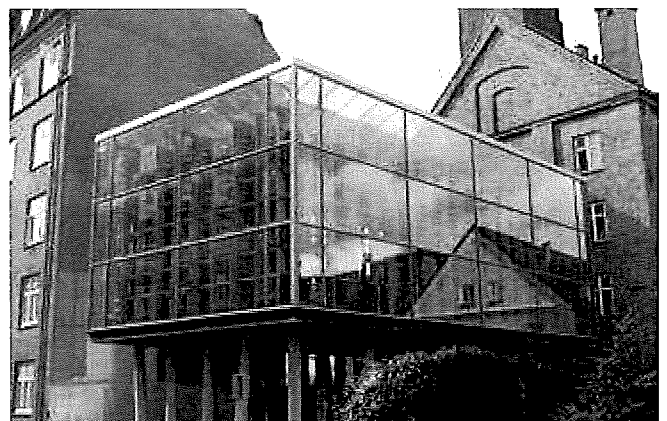
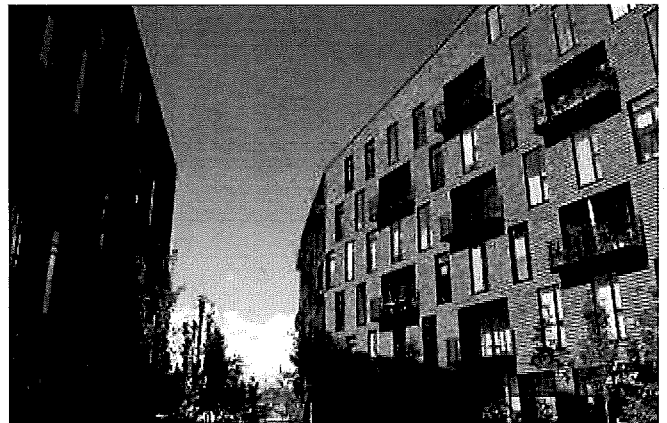
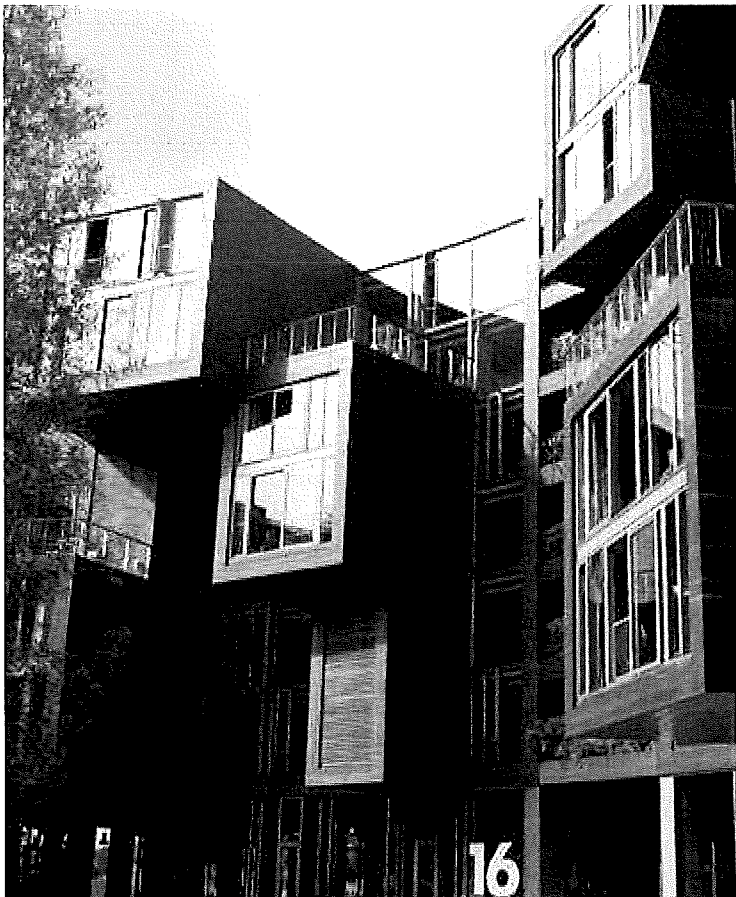

BERLIN

GERMANY

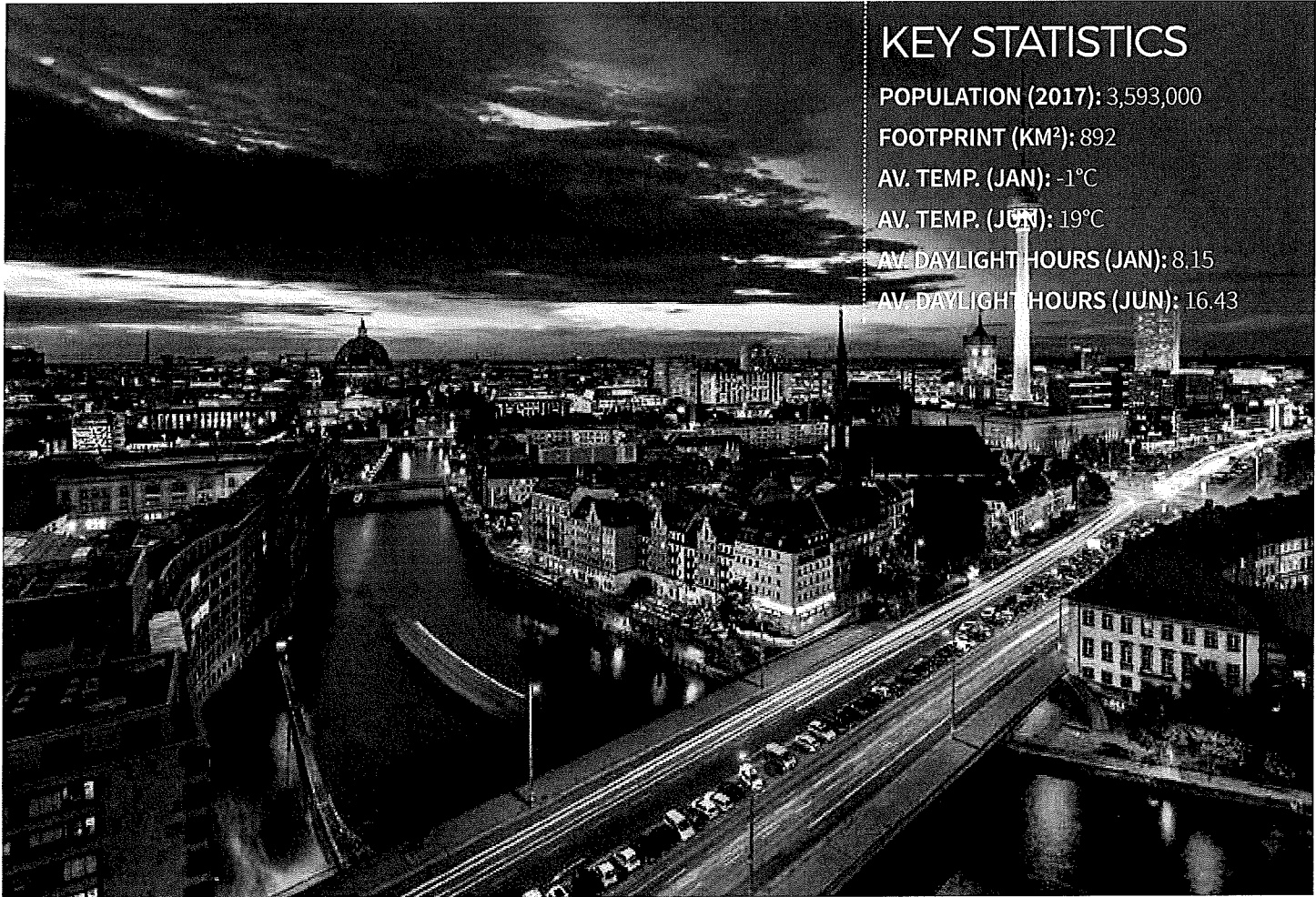

KEY STATISTICS

POPULATION (2017): 3,593,000

FOOTPRINT (KM²): 892

AV. TEMP. (JAN): -1°C

AV. TEMP. (JUN): 19°C

AV. DAYLIGHT HOURS (JAN): 8.15

AV. DAYLIGHT HOURS (JUN): 16.43

WHAT THEY DID

- Meetings with the Berlin Senate Department for Urban Development and the Environment; the Department for the Environment, Transport and Climate Protection; and the German Council for Sustainable Development to learn about Berlin's strategic city plan and sustainable development policies and proposals.
- A meeting and tour of project sites with the founders of CoHousing Berlin, showcased how a self-organised co-housing model in a contemporary setting is working as an alternative housing model for the city.

WHAT THEY LEARNT

COMMUNITY PARTICIPATION

- Planning policies have focused on prioritising people over buildings and ensuring a community focus is at the heart of sustainable development and planning policies.
- The first stage of community consultation focuses on getting the community to agree on what is the objective, then planning the implementation.
- Community participation ensures a strong sense of ownership and respect for a space.

HOUSING AFFORDABILITY AND CO-HOUSING

- Home ownership is very low in the city with 80% of the population renting.
- Housing affordability is a key issue. A current government policy mandates that all new developments have a 25% provision for affordable housing.
- Community-led co-housing is popular in Berlin and provides an alternative to traditional real estate including social housing. Co-housing has delivered housing type diversity that is affordable and innovative.
- 30% of housing ownership is provided through community, deliberative and shared based housing models which realises a saving of between 15-30% to the market rate.
- Open Space in residential developments utilises a mix of communal and private open space, often “blurring the distinction” between private and public spaces.

SMART CITY

- Successful ‘smart city’ strategies involve a multi-agency approach and interconnected thinking to achieve a common goal.
- Smart city initiatives including autonomous buses are piloted in the Moabit district which is designated as the Smart Sustainable District (SSD).

SUSTAINABLE TRANSPORT

- 60% of citizens do not own a car and therefore housing developments are not required to provide parking. A parking space is provided when a purchaser needs it and is prepared to pay for it.

KEY MESSAGE

- A broad range of mechanisms including a reduction in parking availability, improvements in transportation and greater densification are required to reduce the reliance on the private motor vehicle.

USEFUL LINKS

- CoHousing Berlin: <http://www.cohousing-berlin.de/de>
- Smart Sustainable District: <https://ssd-moabit.org/?lang=en>



SINGAPORE

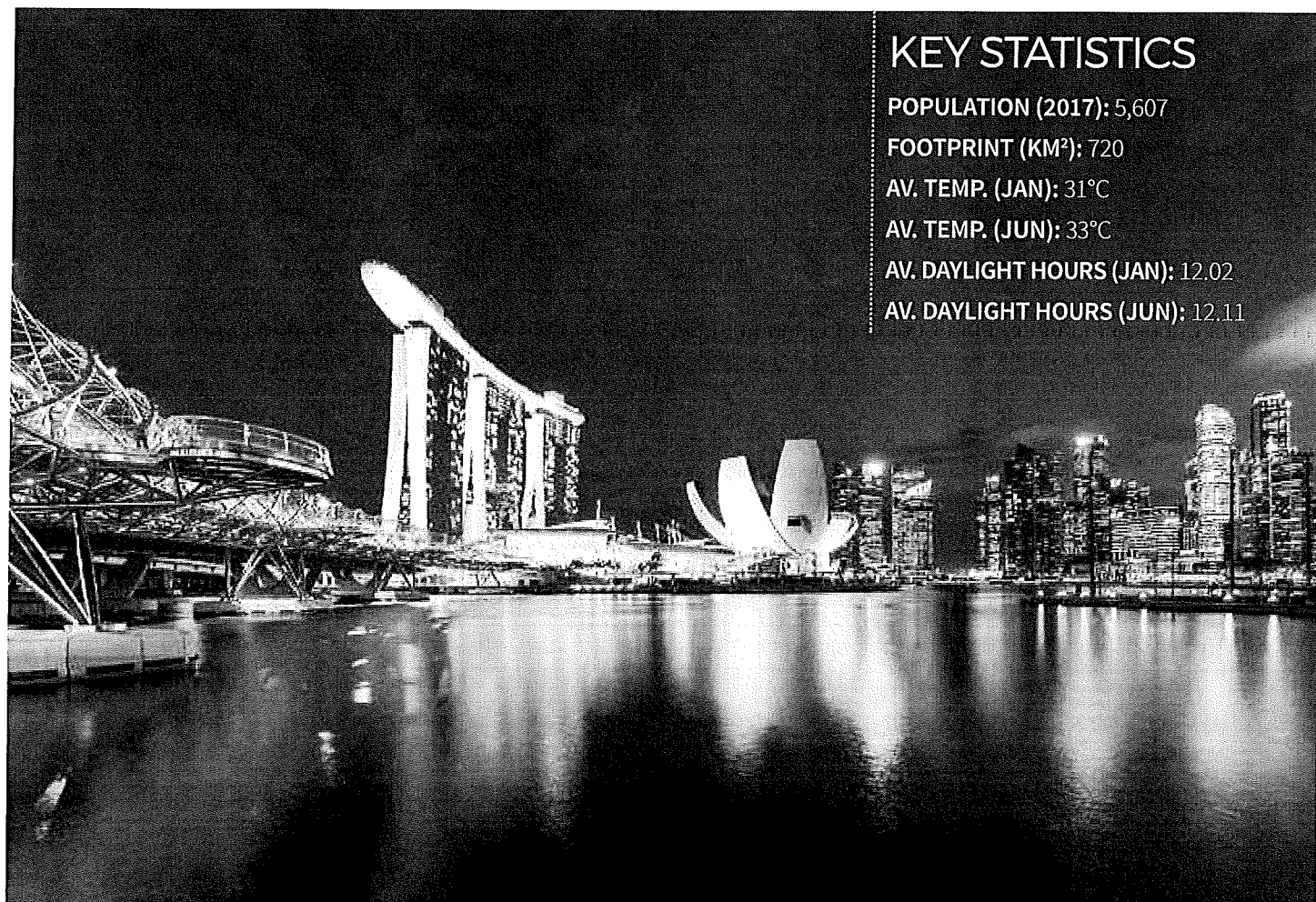

KEY STATISTICS

POPULATION (2017): 5,607

FOOTPRINT (KM²): 720

AV. TEMP. (JAN): 31°C

AV. TEMP. (JUN): 33°C

AV. DAYLIGHT HOURS (JAN): 12.02

AV. DAYLIGHT HOURS (JUN): 12.11

WHAT THEY DID

- Bus tour to see the success of major urban renewal districts of the city including the land-reclamation and renewal of Marina Bay.
- Delegates visited urban rooftop aquaponic farms encouraging a re-think of this often underutilised part of a building.

WHAT THEY LEARNT

SUSTAINABLE TRANSPORT

- Car ownership is managed through high taxation. Car ownership has been steadily decreasing since 2014.
- Provision of good public transport options.

GREEN INFRASTRUCTURE AND PARKS

- Building rooftops are underutilised spaces. Singapore demonstrates that rooftops can produce both local and commercial quality and quantity produce in urban centres.

GOVERNANCE

- The Government has a proactive approach to the city's water infrastructure, already implementing strategies that will ensure the city is self-reliant for water once the Singapore-Malaysia water agreement expires in 2061.

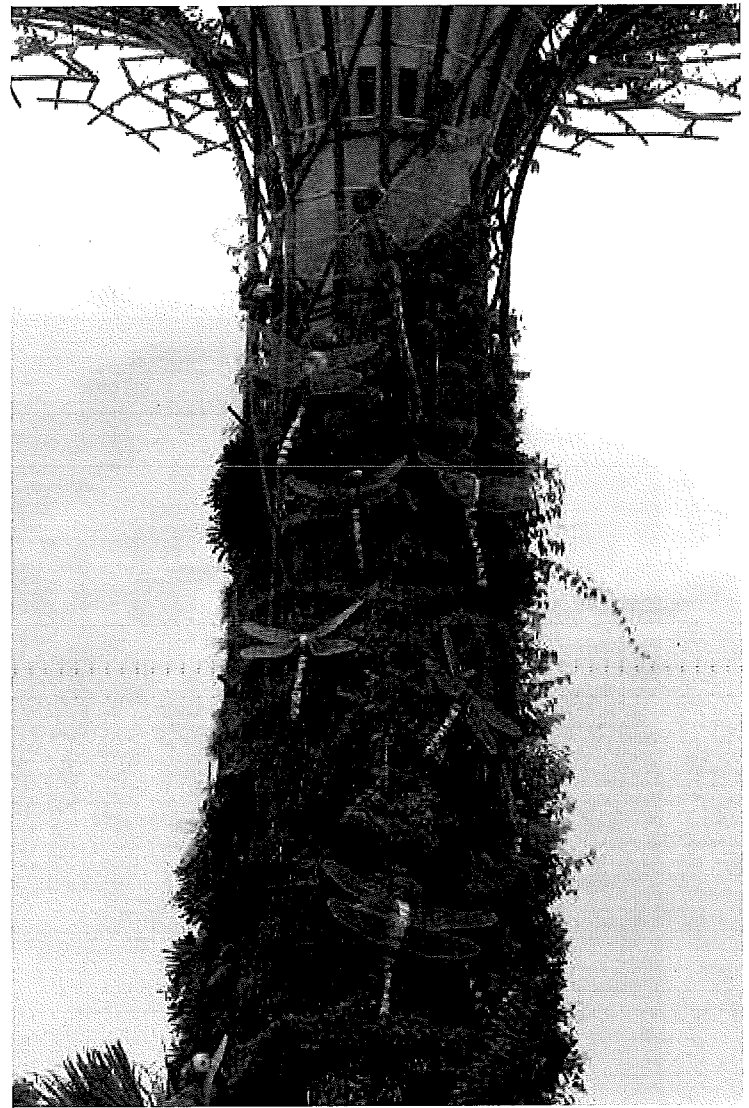

URBAN RENEWAL

- Singapore has used land reclamation extensively to increase its land size, notably in the successful waterfront development of Marina Bay.
- The process of reclaiming land to a stage where development can occur can take over 10 years. Therefore the Government is continually forward planning for future needs.

KEY MESSAGE

- Governments need to be forward thinking and have long term vision and commitment for the city and its infrastructure that expands beyond the terms of political government.

USEFUL LINKS

- Comcrop: <https://comcrop.com/>.
- Urban Redevelopment Authority (Marina Bay): <https://www.ura.gov.sg/uol/master-plan/view-master-plan/master-plan-2008/Growth-Area/City-Centre/Marina-Bay>.



KEY LEARNINGS FOR THE ACT

Learnings to link back to policy thinking will inform:

DESIGN INNOVATION

- Brussels and Prague highlighted the immense impact that quality space and built form design outcomes have for the city, both in a visual and experiential sense. The implementation of the Minister for Planning's Statement of Planning Intent through better design outcomes and the creation of a design review panel will support the ACT in striving for design excellence.
- Every city visited is an exemplar of a global city of varying scales and addressing a range of challenges. The ACT Planning Strategy Refresh provides the opportunity to rethink how we want our city to look and function in the future, taking key ideas from each of these cities and considering them in the Canberra context.

SUSTAINABLE DEVELOPMENT

- Provision of a range of transport options and planning ahead to deliver transport infrastructure as an integrated part of city planning is a key factor to provide for growth.
- The completion of Canberra's transformational light rail network will support the transition to more people adopting active travel, and the city becoming more sustainable and people-friendly.

GREEN INFRASTRUCTURE AND PARKS

- Green infrastructure was a key learning component from Prague, Copenhagen and Singapore. The importance of providing quality public space as density increases is vital as it provides both amenity and ways to address climate change. The examples and learnings will help to inform the ways that the ACT Government can implement its climate change strategy.

COMMUNITY-LED INITIATIVES AND PLACEMAKING

- Copenhagen demonstrated that communities can remain engaged in high levels of public participation for extended periods of time. As cities are about people, encouraging sustained and genuine input from the community will ensure Canberra continues to be a great city to live, work and play for its citizens.

INTEGRATION WITH SMART TECHNOLOGY

- Meetings with Prague's key smart city organisations demonstrated that such initiatives are much more about people than about technology and providing opportunities for innovation. The ACT Government will build on the basis of the signed Canberra-Prague Letter of Intent to advance collaborative information exchange on key topics including smart city technologies.

NEXT STEPS

- An EU World Cities meeting in Canberra is scheduled in March 2018.
- A representative of Gehl Architects is scheduled to visit Canberra in 2018.
- A workshop is planned in Canberra on supporting business to develop space-related technology by the European Space Agency Business Incubation Centre Prague.
- Build on the Letter of Intent signed by Canberra and Prague to share innovation and technology ideas and developments.
- Progress collaborative knowledge exchange with EU cities on key initiatives such as: renewable and sustainable energy initiatives, sustainable transport, smart cities and supporting sustainable communities and affordable housing.
- Continue to build and support cooperative relationships across governments and businesses in EU cities and Singapore.
- Pursue a memorandum of understanding with the Innovation Hub and CBR Innovation Network to support start-ups and project innovation particularly focussed on young people.
- Develop a joint exchange program to support innovation and entrepreneurship through collaboration on start-ups.
- Use the learnings from this trip as examples to consider in the Planning Strategy Refresh in 2018.

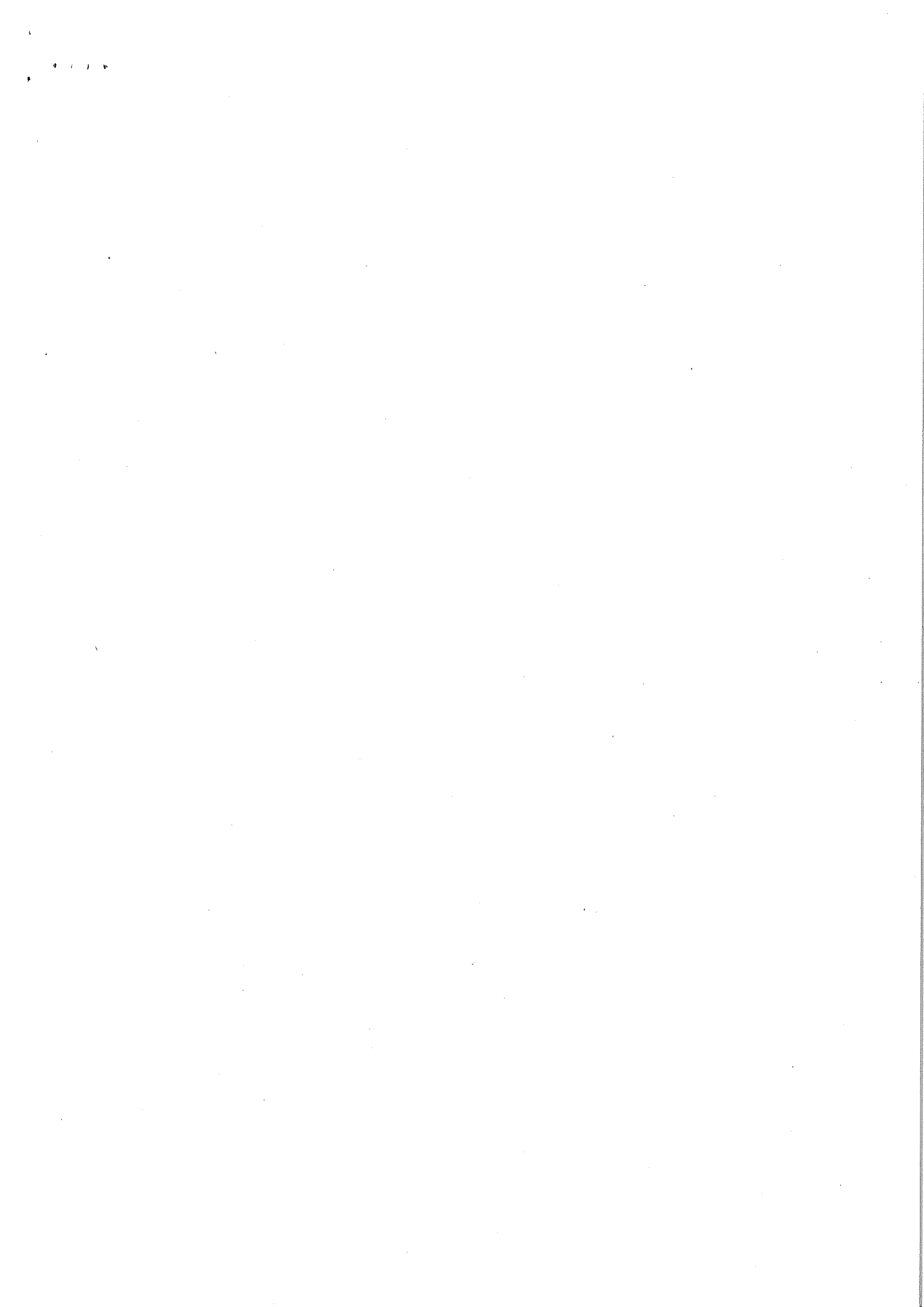

EUROPEAN
UNION AND
SINGAPORE
12-DAY STUDY TOUR

2017

**THE LEGISLATIVE ASSEMBLY FOR THE
AUSTRALIAN CAPITAL TERRITORY**

MINISTERIAL STATEMENT

EUROPEAN UNION DELEGATION AUGUST/SEPTEMBER 2017

**Mr Mick Gentleman MLA
Minister for Planning and Land Management**

Introduction

Madam Speaker, it is with great pleasure that I make a statement here today about the ACT Government's commitment under the European Union's World Cities Program.

In my capacity as Minister for Planning and Land Management, I recently had the opportunity to lead a delegation of ACT Government and industry leaders on a 12-day study tour of Europe and Singapore as part of the European Union's World Cities Program.

Today I take the opportunity to table a report highlighting the key learnings and insights from this recent study tour.

About the European Union (EU) World Cities program

The World Cities program is an initiative of the Directorate General for Regional and Urban Policy of the European Commission in the framework of the European Parliament. It seeks to promote an exchange of experience and best practice between EU and non-EU countries.

Under the World Cities Program, Prague is the partner city for Canberra.

In recognition of the partnership developing between Canberra and Prague under the EU World Cities Program, I had the privilege to sign on behalf of the ACT Government a Letter of Intent with Prague City Hall. Ms Kristýna Kučerová, Deputy Director of Prague Startup Centre was the joint signatory.

This Letter of Intent sets out the agreement to the exchange of experience and best practice through community, business and government partnerships for the promotion of innovation and sustainable solutions.

With examples being the mutual exchange regarding smart city technologies and renewable energy initiatives.

The ACT Government will build on the Canberra-Prague Letter of Intent to continue to develop on-going information exchange on key topics including smart city technology and advances and fostering ideas on good design.

EU Delegation study tour

Following the World Cities Program initial meeting in Melbourne Australia, the Prague delegation visited Canberra in May 2017. They were particularly interested in our renewable technologies.

The ACT's hospitality was returned by Prague and the EU in August 2017.

The delegation comprised myself, Mr Ben Ponton (Director-General for the Environment, Planning and Sustainable Development Directorate) and my senior advisor.

Five members from the ACT Branch of the Property Council of Australia undertook a concurrent, self-funded tour of the same cities.

The tour was focussed on five themes. Seeking to further the ACT's interests in pursuing excellence in sustainable development and design, and best practice community-led initiatives, the themes were designed around:

1. Design innovation
2. Sustainable development
3. Green infrastructure and parks
4. Community-led initiatives and place-making
5. Integration with smart technology.

Each city provided many insights to me and the other delegates about how the cities meet contemporary challenges. By looking at best practice examples across Europe and Singapore and combining this with meetings and discussions about their planning system, it aided my understanding on how good design and business opportunities can be combined to innovate in all areas of city management.

I was keenly aware of the value of quality space and building design in Brussels and Prague. While cities such as Copenhagen and Berlin, technology has been embraced and it infiltrates all areas of city management to help reduce greenhouse gas emissions and build resilience for climate change impacts..

Several European centres demonstrated how dilapidated industrial areas were transformed into diverse and attractive urban neighbourhoods. Illustrating a respectful relationship between new buildings with their older, historic neighbours.

In Copenhagen, I saw how car parking for residential buildings is not located on-site, but in centralised locations up to 200 metres away. With these carparks built as multi-purpose community areas featuring green space, playgrounds and recreation spaces. While in Singapore we saw how fresh food is grown commercially right in the heart of the city on rooftops. These learnings will help to inform the ACT Government's work to address climate change.

In Copenhagen I learned that communities can remain engaged with high levels of public participation for extended periods of time. As cities are about people, encouraging sustained and genuine input from the community will ensure Canberra continues to be a great city for its citizens.

Conclusion

As the Minister for Planning and Land Management, I look forward to ongoing collaboration with Prague under the EU World Cities Program. In particular to continue to build cooperative relationships across governments and businesses.

To this end, the ACT Government is scheduled to host an EU World Cities meeting in Canberra in March 2018.

It is therefore with great pleasure that I take this opportunity to commend the EU World Cities Program to members and to table this report of the EU delegation study tour.

LETTER OF INTENT BETWEEN CANBERRA, AUSTRALIA AND PRAGUE STARTUP CENTRE, PRAGUE, CZECH REPUBLIC

29 August 2017

This Letter of Intent sets out the agreement to the exchange of experience and best practice through community, business and government partnerships for the promotion of innovation and sustainable solutions facilitated by the European Union (EU) World Cities Project.

Specifically, the agreement will be delivered through a commitment to the following activities:

- Collaboration and knowledge sharing about urban renewal and sustainable growth
- Mutual exchange regarding renewable and sustainable energy initiatives
- Collaboration for the development of sustainable transport solutions
- Mutual exchange regarding smart city technologies and implantation
- Collaboration for the development of community services and affordable housing solutions
- Mutual exchange of delegations that connect businesses of each city
- Jointly support innovation and entrepreneurship through the collaboration of start-up ecosystems

This letter should come into force upon signing by both parties and be terminated on the notification from either party in written form 3 months in advance.



Mick Gentleman MLA
Minister for Planning and Land Management
Australian Capital Territory



Kristýna Kučerová
Deputy Director
Prague Startup Centre



ACT
Government

PRAGUE 
STARTUP CENTRE